

Hour run or Elapsed time Meter Din panel, Analog meter

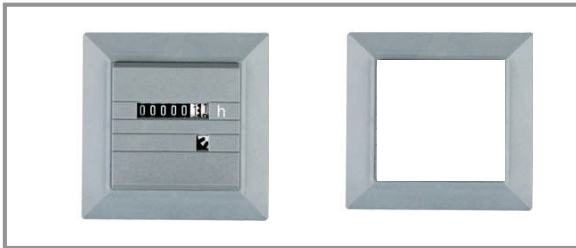

Application

Square panel meters for alternating current system. All panel meters are direct indication of measuring input. They are suitable to use on the distribution panel, control panel, switchboard panel, power plant, mimic board, machines and others.

The instruments has designed for industrial applications which required precise, reliable and robust instruments for the display range and indicating. Elapsed Time Meter or Hours Run Meters use to monitor ON time or RUN time of plant, machine or others equipments to allow user to perform and verify on production efficiency, cost estimate, services period monitoring for preventive maintenance etc. The time measure of 0.01h upto 99999.99 hours. Each measuring instrument is suited for one of the following measuring tasks:

- Hour meter with direct connection 100V, 240V
- Frequency operating 50 Hz. or 60 Hz..

Dimension

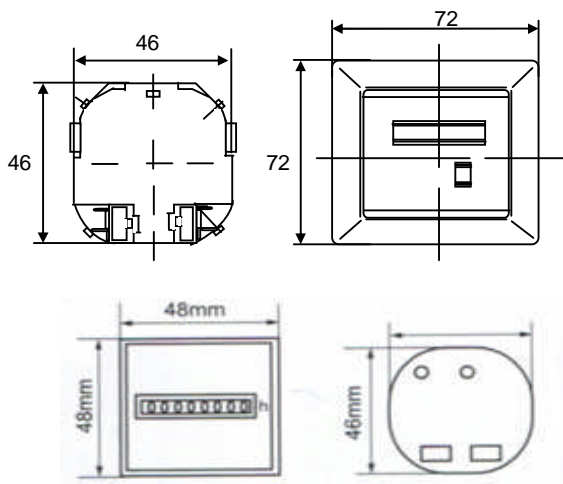

48x48mm no front plate
72x72mm with front plate

- Front Dimension 72x72mm with front plate.
- DIN43700, DIN43802, DIN43718, IEC1010, IEC473, IEC51, BS89
- Polycarbonate, self extinguishing and drip-proof per UL94V-0
- Rugged housing-non combustible, plastic-heat resistance.
- Display Range 99999.99
- Hi resolution 0.01
- Indication Clearly Even Power Failure

Characteristic

Display

Scale Graduation
Pointer

Electro-mechanic
Numeric display 99999.99 comply with
DIN 43802, parts 2 through 4.

Mechanical Design

Housing Material

Polycarbonate, self-extinguishing and drip-proof
per UL94V-0

Mounting Fasteners

Standard type screw clamp

Front plate

Interchangeable scales

Terminals

Front plate replaced with voltage-free conditions!
M4 screw terminals with self-lifting terminal clips.

Screws can be turned with standard screw
drivers tool.

Contact Protection

Finger-safe full cover included

Consumption

Voltage Path

3.3VA for direct connection.

Voltage Path

2.0VA for PT Rated.

Ambient Conditions

Operating Temperature

- 20 ... + 55 °C

Storage Temperature

- 40 ... + 70 °C

Relative Humidity

max. 95%

Frequency

45...65Hz.

Compliance with Regulations

Protection

IP 52, front panel, Terminal IP20

Protection

Class 1

Size	72x72mm
Type	BZ142
Weight	0.40 Kg.
Panel Cutout	46x46 mm.
Max Voltage	300 V
Test Voltage	2.2 Kv

Ordering Information.

1) Model

BZ142

2) Input Type

Voltage

100, 110, 115, 120, 240V ac

3) Scale Range

Factory standard range or consult.

4) Operating Frequency

50 Hz.Or 60Hz.*

* please specify when ordering

Example

1) BZ142 Hour Meter Input 240Vac, 50 Hz.*

* specify when ordering or consult.

Wiring Diagram.

